

BLACK+
DECKER

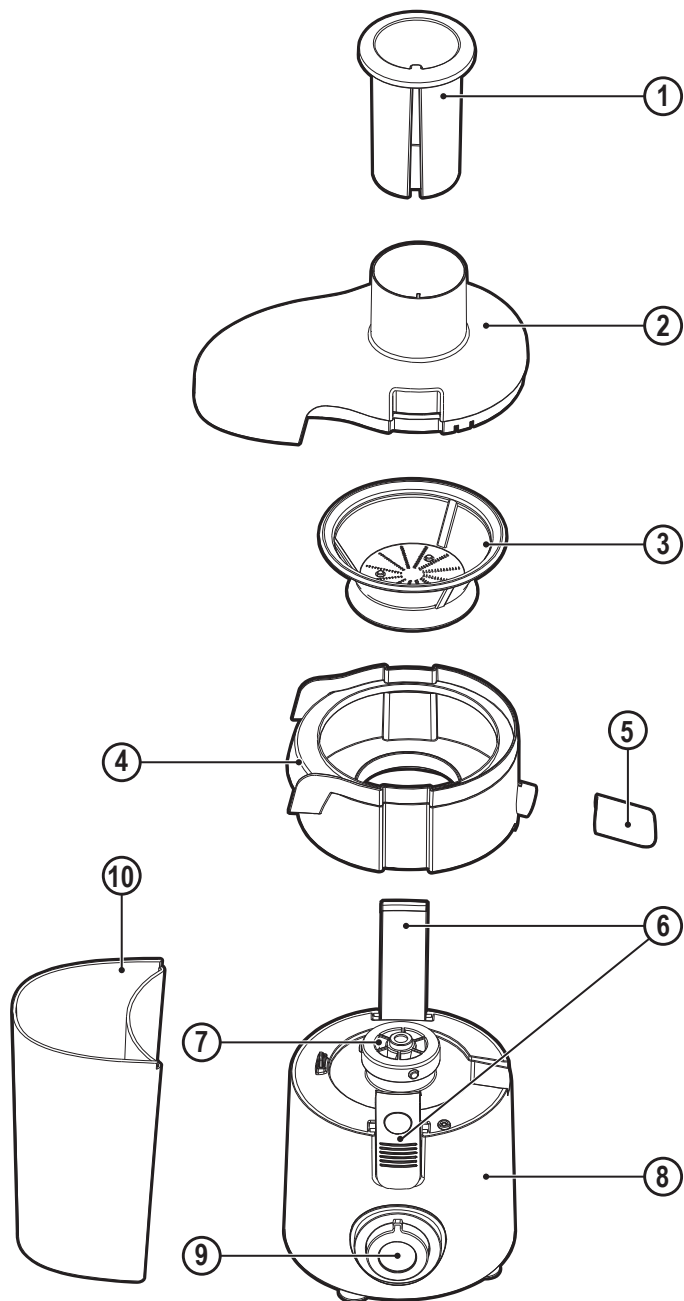



Intended use

Your BLACK+DECKER JE250 and juicer has been designed for extracting juice from fruit and vegetables.

This appliance is intended for indoor household use only.

This appliance is not intended to be used in:

- ◆ Staff kitchen areas in shops, offices and other working environments;
- ◆ Farm houses;
- ◆ By clients in hotels, motels and other residential type environments;
- ◆ Bed and breakfast type environments;

Thank you for choosing BLACK+DECKER. We hope that you will enjoy using this product for many years. For indoor and domestic use only.

In order to avoid a hazard due to inadvertent resetting of the thermal cut-out, this appliance must not be supplied through an external switching device, such as a timer, or connected to a circuit that is regularly switched on and off by the utility



Safety instructions

- ◆ **Warning!** When using mains-powered appliances, basic safety precautions, including the following, should always be followed to reduce the risk of fire, electric shock and personal injury.
- ◆ Read all of this manual carefully before using the appliance.
- ◆ In order to avoid a hazard due to inadvertent resetting of the thermal cut-out, this appliance must not be supplied through an external switching device, such as a timer, or connected to a circuit that is regularly switched on and off by the utility.
- ◆ The intended use is described in this manual. The use of any accessory or attachment or the performance of any operation with this appliance other than those recommended in this instruction manual may present a risk of personal injury.
- ◆ Retain this manual for future reference.

Using your appliance

- ◆ Always take care when using the appliance.
- ◆ Do not use the appliance outdoors.
- ◆ Do not operate the appliance if your hands are wet. Do not operate the appliance if you are barefoot.
- ◆ Guide the power supply cord neatly so it does not hang over the edge of a worktop and cannot be caught accidentally or tripped over.
- ◆ Never pull the power supply cord to disconnect the plug from the socket. Keep the power supply cord away from heat, oil and sharp edges.

- ◆ If the supply cord is damaged, it must be replaced by the manufacturer, its service agent or similarly qualified persons in order to avoid a hazard.
- ◆ Disconnect the appliance from the power supply when not in use and before cleaning.
- ◆ Do not fill the appliance above the maximum level.
 - ◆ Overfilling the appliance could cause a hazard.
 - ◆ Overfilling the appliance could cause water to spill.

Safety of others

- ◆ This appliance is not intended for use by persons (including children) with reduced physical, sensory or mental capabilities, or lack of experience and knowledge, unless they have been given supervision or instruction concerning use of the appliance by a person responsible for their safety.
- ◆ Children should be supervised to ensure that they do not play with the appliance.

After use

- ◆ Switch off, remove the plug from the socket and let the appliance cool down before leaving it unattended and before changing, cleaning or inspecting any parts of the appliance.
- ◆ When not in use, the appliance should be stored in a dry place. Children should not have access to stored appliances.

Inspection and repairs

- ◆ Before use, check the appliance for damaged or defective parts. Check for breakage of parts, damage to switches and any other conditions that may affect its operation.
- ◆ Do not use the appliance if any part is damaged or defective.
- ◆ Have any damaged or defective parts repaired or replaced by an authorised repair agent.
- ◆ Before use, check the power supply cord for signs of damage, ageing and wear.
- ◆ Do not use the appliance if the power supply cord or mains plug is damaged or defective.
- ◆ If the power supply cord or mains plug is damaged or defective it must be repaired by an authorised repair agent in order to avoid a hazard. Do not cut the power supply cord and do not attempt to repair it yourself.
- ◆ Never attempt to remove or replace any parts other than those specified in this manual.
- ◆ Allow moving parts to come to a stop before removing any cover.
- ◆ Do not immerse the appliance, cord set or plug in any liquids.
- ◆ Unit must be attended in use.
- ◆ Keep loose clothes & long hair away from the inlet chute & any moving parts.

- ◆ Take care when handling the sharp cutting blades, when emptying the bowl and during cleaning.



Warning! Sharp blades, always use the food plunger, keep fingers out of juicer opening and moving parts.

Additional safety instructions for Juicers

Warning! Do not place near a hot gas or electric oven.

- ◆ Use the original components only.

Caution: Ensure that the appliance is switched off before performing any maintenance or cleaning.

- ◆ Misuse could cause injury.
- ◆ Do not use the appliance if the rotating sieve or the protective cover is damaged or has visible cracks.
- ◆ If an extension lead is used, it must be earthed.
- ◆ Only use with the accessories provided.
- ◆ Leave adequate space around the appliance for ventilation.
- ◆ Disconnect the appliance from the electrical supply before cleaning or carrying out any maintenance, changing accessories or approaching parts that move when in use.
- ◆ Keep children and animals away from the appliance and cord set.
- ◆ Close supervision is required when using the appliance near children.
- ◆ This appliance is not intended to be operated by means of an external timer or a separate remote control system.

Electrical safety

Before use, check that the mains voltage corresponds to the voltage on the rating plate.



This appliance is double insulated in accordance with IEC 60335-2-14; therefore no earth wire is required.

- ◆ Appliance plugs must match the outlet. Never modify the plug in any way.
- ◆ Do not use any adapter plugs with earthed (Class 1) appliances. Unmodified plugs and matching outlets will reduce the risk of electric shock.
- ◆ To avoid the risk of electric shock, do not immerse the cord, plug or appliance in water or other liquid.
- ◆ If the supply cord is damaged, it must be replaced by the manufacturer, its service agent or similarly qualified persons in order to avoid a hazard

Extension cables

- ◆ Up to 30m (100 ft) can be used without loss of power.
- ◆ If the supply cord is damaged, it must be replaced by the manufacturer or an authorised BLACK+DECKER Service Centre in order to avoid a hazard.

Symbols on appliance

The following symbols are shown on the tool along with the date code:

Features

1. Plunger
2. Lid/protective cover
3. Grater
4. Filter basket
5. Spout
6. Securing clamp
7. Motor wheel
8. Main body
9. On/off switch
10. Residue collection cup

Use

- ◆ Sit the appliance on a stable, level surface.
- ◆ Leave a space of at least 50mm all around the appliance.

Note: The appliance only functions if all parts are properly assembled and the lid is properly locked in place with the clamps.

- ◆ Before plugging unit into power source, make sure the switch is off and the securing clamps are safely locked.
- ◆ Wash fruits and vegetables well. Cut fruits into small pieces so they can fit into the feeding funnel.
 - ◆ The juice extractor cannot process bananas, peaches, apricots, mangos, Papayas, etc. because no juice can be squeezed from those fruits.
 - ◆ The juice extractor cannot process coconut or other hard items because they may damage the motor and filter.
 - ◆ Skins must be removed from citrus fruits, remove pits from cherries. Prunes, etc. before feeding them into the funnel.
 - ◆ The juice extractor is not suitable for processing succulent fruits or fruits with low juice viscosity, such as watermelons, oranges, etc.
- ◆ Switch the power ON.
- ◆ Insert the prepared fruits into the feeding funnel and gently push the plunger down.
- ◆ When residue or juice cups are full, switch the power OFF and empty the containers before continuing to process.

Warning! Grater has sharp blades - always use pusher, be careful of moving parts. Keep fingers out of feeder and discharge openings. Unplug unit before cleaning and before assembling and removing parts.

Warning! Do not run juicer continuously for longer than 60 seconds. Turn off switch and let it rest for at least 15 minutes to cool down the motor, and to clean.

Helpful hints and tips

- ◆ The best results are obtained when using young and particularly fresh vegetables and fruits. In general, the softer the vegetable and riper the fruit, the thicker and less clear the juice will be.
- ◆ Wash fruits and vegetables and dry them well, if possible.
- ◆ Cut fruits and carrots into strips.
- ◆ Roll leafy vegetables into clumps.

Juicing Guide

Fruit/Vegetables	Vitamins/Minerals	Calories	Speed
Apples	Vitamin C	200g = 72cals	High
Apricots	High in dietary fibre, contains potassium.	30g = 20cals	Low
Beetroot	Good source of folate, dietary fibre, vitamin c and potassium	160g = 45cals	High
Blueberries	Vitamin C	125g = 70cals	Low
Brussel sprouts	Vitamin C, B, B6, E folate and dietary fibre.	100g = 26cals	Low
Cabbage	Vitamin C, B6 folate potassium, and dietary fibre	100g = 26cals	High
Carrots	Vitamin A, C, B6, dietary fibre	120g = 30cals	High
Celery	Vitamin C and potassium	80g = 7cals	High
Cucumber	Vitamin C	280g = 29cals	Low
Fennel	Vitamin C, dietary fibre	300g = 35cals	Low
Kiwi fruit	Vitamin C, potassium	100g = 40cals	Low
Grapes	Vitamin C, B6 and potassium	125g = 85cals	Low
Melons	Vitamin C, A, folate, dietary fibre	200g = 50cals	Low
Nectarines	Vitamin C, B3, potassium, dietary fibre	180g = 85cals	High
Peaches	Vitamin C, B3, potassium, dietary fibre	150g = 49cals	High
Pears	Dietary fibre	150g = 60cals	High
Pineapple	Vitamin C	150g = 59cals	High
Raspberries	Vitamin C, iron, potassium and magnesium	125g = 31cals	Low
Tomatoes	Vitamin C, dietary fibre, vitamin E, folate and vitamin A	1000g = 22cals	Low

Troubleshooting

Problem	solution
The appliance does not work.	The appliance is equipped with a safety system, it dose not work if the parts have not been assembled properly, check whether the parts have been assembled in the right way, but switch off the appliance before you do so.
The motor unit gives off an unpleasant smell the first few times the appliance is used.	This is not unusual, if the appliance continues to give off this smell after a few times, check the quantities you are processing and the processing time.

The appliance makes a lot of noise, gives off an unpleasant smell, is too hot to touch, gives off smoke etc.	Switch off the appliance and unplug it, go to the nearest BLACK+DECKER service center or your dealer for assistance.
The filter is blocked.	Switch off the appliance, clean the feeding tube and the filter and process a smaller quantity.

Cleaning and maintenance

Warning! Before cleaning and maintenance, switch the appliance off and remove the plug from the socket.

Warning! Allow the unit to thoroughly cool down before attempting to clean it.

- ◆ Open the securing clamps, remove the container cover, upper body and the filter. Clean these parts under running water. Do not use a dishwasher or very hot water.
- ◆ To clean the filter, a small toothbrush (not included) is recommended.

Warning! do not immerse motor housing in water or any other liquid. Motor must always be kept dry.

- ◆ Use a damp cloth to clean the motor housing.
- ◆ Do not use abrasive cleaners or scouring pads to clean the unit.
- ◆ Keep the power cord clean and dry, otherwise it may cause problems.
- ◆ Reassemble all parts in proper order and store the appliance in a dry place.

Mains plug replacement

If a new mains plug needs to be fitted:

- ◆ Safely dispose of the old plug.
- ◆ Connect the brown lead to the live terminal in the new plug.
- ◆ Connect the blue lead to the neutral terminal.
- ◆ If the product is class I (earthed), connect the green/yellow lead to the earth terminal

Note! If your product is class II double insulated (only 2 wires in the cord set), no connection is to be made to the earth terminal.

Follow the fitting instructions supplied with good quality plugs.

Any replacement fuse must be of the same rating as the original fuse supplied with the product.

Warning! The above section on mains plug replacement is for authorized service centre persons **Protecting the environment**



Separate collection. Products and batteries marked with this symbol must not be disposed of with normal household waste.

Products and batteries contain materials that can be recovered or recycled reducing the demand for raw materials. Please recycle electrical products and batteries according to local provisions. Further information is available at www.2helpU.com

Technical data

		JE250
Input voltage	V_{AC}	220 - 240
Power input	W	250

**United Kingdom &
Republic Of Ireland**
www.blackanddecker.co.uk
emeaservice@sbdinc.com

Black & Decker
210 Bath Road
Slough, Berkshire SL1 3YD

Tel. 01753 511234
Fax 01753 512365
